

FBE20T STEAM TOUCH PANEL ELECTRICAL COMBI OVEN

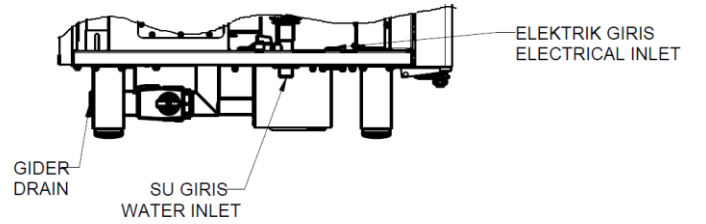
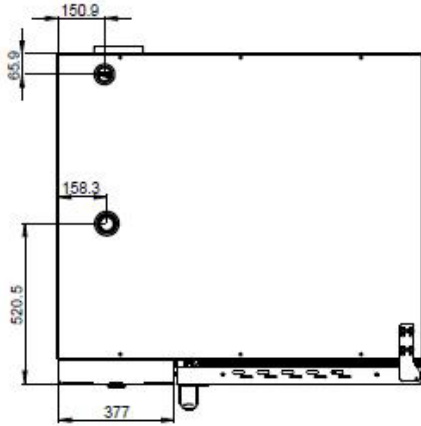
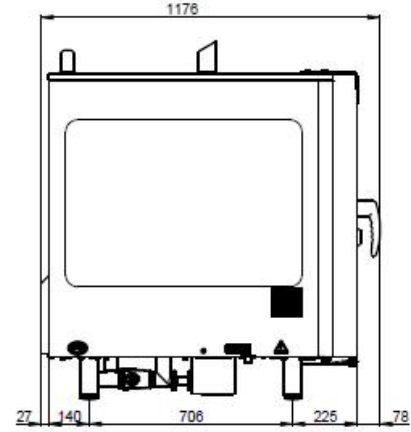
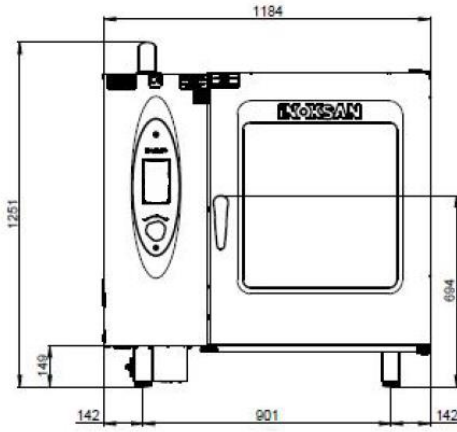

GENERAL SPESIFICATION

- * It is manufactured from AISI304 18/8 Cr-Ni stainless steel sheet
- * It has a touch panel on the oven
- * Cooking temperature and time can be set manually on the touch control panel
- * One touch control select five different cooking modes (turbo mode (30-300°C), steam mode (100°C), combi mode (30-300°C), adjustable steam mode (30-99°C), banquette mode (30-300°C))
- * Steam/dry temperature adjustable boiler adjustment
- * 60 piece recipe cooking quick recipe
- * 60 piece recording recipes
- * Favorite cooking recipe feature
- * 4 different language options and melodic sound warning
- * Steam cooking function (separate cooking for each shelf)
- * 6 phase steps during cooking
- * Automatic preheating option
- * Intelligent steam generator
- * Steam generator and limit thermostat in cabin interior
- * Automatic filling system and powerful steam generator
- * 5 points measured (30-99°C) – meat probe
- * Self Cooling
- * Automatic washing system with 3 program (little, medium, intensive)
- * Flexible hose to wash the cabin manually.
- * Steam condenser system
- * 2 step oven door lock system
- * Double glass technology that prevents heat loss
- * Open drainage (drainage with automatic open and close in models with washing feature)
- * Error alert system

TECHNICAL SPESIFICATION

Steam Gas Power	17,5	kW
Fan Motor Power	0,85	kW
Electrical Inlet	400 V AC 3N+PE	V
Frequency	50-60	Hz
Max. Electrical Power	25+1	kW
Cooking Capacity	GN 1/1*20	piece
Capacity	10 GN 2/1 veya 20 GN 1/1	
Distance Of Shelves	65	mm
Water Pressure	2-4	bar
Water Inlet	¾	INC
Diemensions	1180x1070x1190	WxDxH
Cooking Chamber Volumes	0,42	m³
Net Weight	244	KG
Gross Weight	268	KG